



PRODUCT PAGE



Maximum versatility and performance

CUSTOM HYDRAULIC PUMPS ON REQUEST



- The FPT model hydraulic pumps are the ideal solution for all industrial applications because of their extreme versatility and customization thanks to multiple configurations.
- Available with three-phase and single-phase electric motor or pneumatic.
- Possibility to install manual, electric or pneumatic, 3 or 4-way valves for single or double-acting cylinders and hydraulic equipment.
- With strong steel tank from 10 to 100 liters.
- Reduced maintenance. Designed to last.
- Wide range of accessories.
- Possibility to design and produce custom hydraulic pumps on request, with dedicated performance and features.
- Available models ATEX version. ▶



FPT

700 bar
Single – Double stage
0,9/0,45 - 7,5/0,9 l/min oil flow
From 10 to 60 l capacity

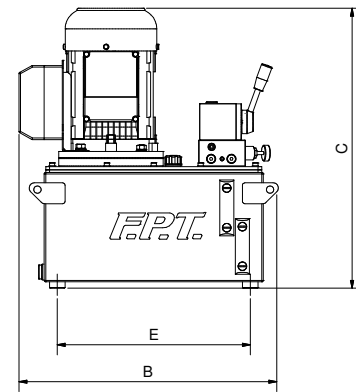
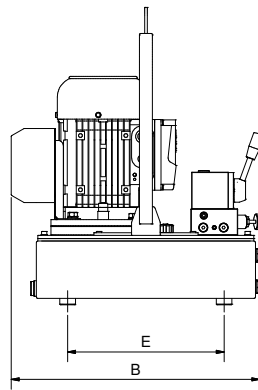
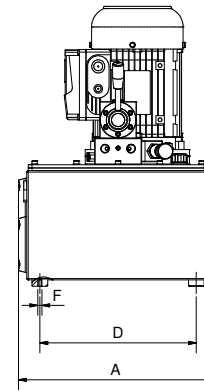
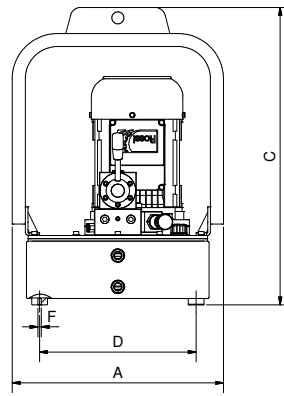

10L

20-40-60-100 L

| MODEL | PRESSURE RATING 1st/2nd STAGE | OIL DISPLACEMENT 1st/2nd STAGE | MOTOR | KW RPM |
|--------------|----------------------------------|-----------------------------------|----------------------|------------|
| | bar | l/min | | |
| FPT 1 - ME4 | 100 / 700 | 0,9 / 0,45 | THREE-PHASE 4 POLES | 1,1 / 1450 |
| FPT 1 - ME41 | | 0,9 / 0,45 | SINGLE-PHASE 4 POLES | 1,1 / 1450 |
| FPT 1 - ME2 | | 1,8 / 0,9 | THREE-PHASE 2 POLES | 2,2 / 2850 |
| FPT 1 - ME21 | | 1,8 / 0,9 | SINGLE PHASE 2 POLES | 2,2 / 2850 |
| FPT 1 - MA | | 1,8 / 0,9 | PNEUMATIC | 2,6 / 3000 |
| FPT 2 - ME4 | 700 | 0,9 | THREE-PHASE 4 POLES | 1,1 / 1450 |
| FPT 2 - ME41 | | 0,9 | SINGLE-PHASE 4 POLES | 1,1 / 1450 |
| FPT 2 - ME2 | | 1,8 | THREE-PHASE 2 POLES | 2,2 / 2850 |
| FPT 2 - ME21 | | 1,8 | SINGLE PHASE 2 POLES | 2,2 / 2850 |
| FPT 2 - MA | | 1,8 | PNEUMATIC | 2,6 / 3000 |
| FPT 5 - ME4 | 70 / 700 | 2,5 / 0,9 | THREE-PHASE 4 POLES | 1,1 / 1450 |
| FPT 5 - ME41 | | 2,5 / 0,9 | SINGLE-PHASE 4 POLES | 1,1 / 1450 |
| FPT 5 - ME2 | | 4,5 / 1,8 | THREE-PHASE 2 POLES | 2,2 / 2850 |
| FPT 5 - ME21 | | 4,5 / 1,8 | SINGLE PHASE 2 POLES | 2,2 / 2850 |
| FPT 5 - MA | | 4,5 / 1,8 | PNEUMATIC | 2,6 / 3000 |
| FPT 9 - ME4 | 70 / 700 | 3,5 / 0,45 | THREE-PHASE 4 POLES | 1,1 / 1450 |
| FPT 9 - ME41 | | 3,5 / 0,45 | SINGLE-PHASE 4 POLES | 1,1 / 1450 |
| FPT 9 - ME2 | | 7,5 / 0,9 | THREE-PHASE 2 POLES | 2,2 / 2850 |
| FPT 9 - ME21 | | 7,5 / 0,9 | SINGLE PHASE 2 POLES | 2,2 / 2850 |
| FPT 9 - MA | | 7,5 / 0,9 | PNEUMATIC | 2,6 / 3000 |

| MOTOR | OILTANK CAPACITY | DIMENSIONS (mm) | | | | | | WEIGHT kg |
|-----------------|------------------|-----------------|-----|-----|-----|-----|-----|--------------|
| | | A | B | C | D | E | F | |
| Electric ME | 10 | 405 | 480 | 580 | 300 | 300 | M8 | 36 |
| | 20 | 380 | 500 | 540 | 300 | 370 | M8 | 49 |
| | 40 | 610 | 490 | 540 | 500 | 370 | M8 | 69 |
| | 60 | 860 | 490 | 540 | 750 | 370 | M8 | 91 |
| | 100 | 935 | 580 | 610 | 670 | 470 | M10 | 152 |
| Pneumatic MA | 10 | 405 | 450 | 580 | 300 | 300 | M8 | 33 |
| | 20 | 380 | 480 | 440 | 300 | 370 | M8 | 46 |
| | 40 | 610 | 450 | 440 | 500 | 370 | M8 | 56 |
| | 60 | 860 | 490 | 440 | 750 | 370 | M8 | 87 |
| | 100 | 935 | 580 | 510 | 670 | 470 | M10 | 148 |

Pneumatic and Electric pump's dimensions – NO CAGE

| MOTOR | OILTANK CAPACITY | DIMENSIONS (mm) | | |
|--------------------------------------|------------------|-----------------|-----|-----|
| | | A | B | C |
| Electric and Pneumatic ME - MA | 10 | 470 | 570 | 570 |
| | 20 | 470 | 620 | 620 |
| | 40 | 750 | 540 | 620 |
| | 60 | 1000 | 540 | 620 |
| | 100 | 1000 | 700 | 755 |

Pneumatic and Electric pump's dimensions – WITH CAGE